

Kārearea

3 Bdrm / 169m²

Do you have an eye for sharp, modern design? Discover Kārearea. Floor to soffit windows overlook fabulous views. The generously sized kitchen has a separate pantry, there's excellent storage, and the garage has a great workshop layout.

- 3 BEDROOMS
- 2 LIVING ROOMS
- 2 TOILETS
- 1 BATHROOM
- 2 CAR GARAGE
- 1 WALK-IN ROBE
- 1 ENSUITE
- LAUNDRY



KEY FEATURES OF THIS HOME

- Brick veneer
- Open plan living
- Double garage

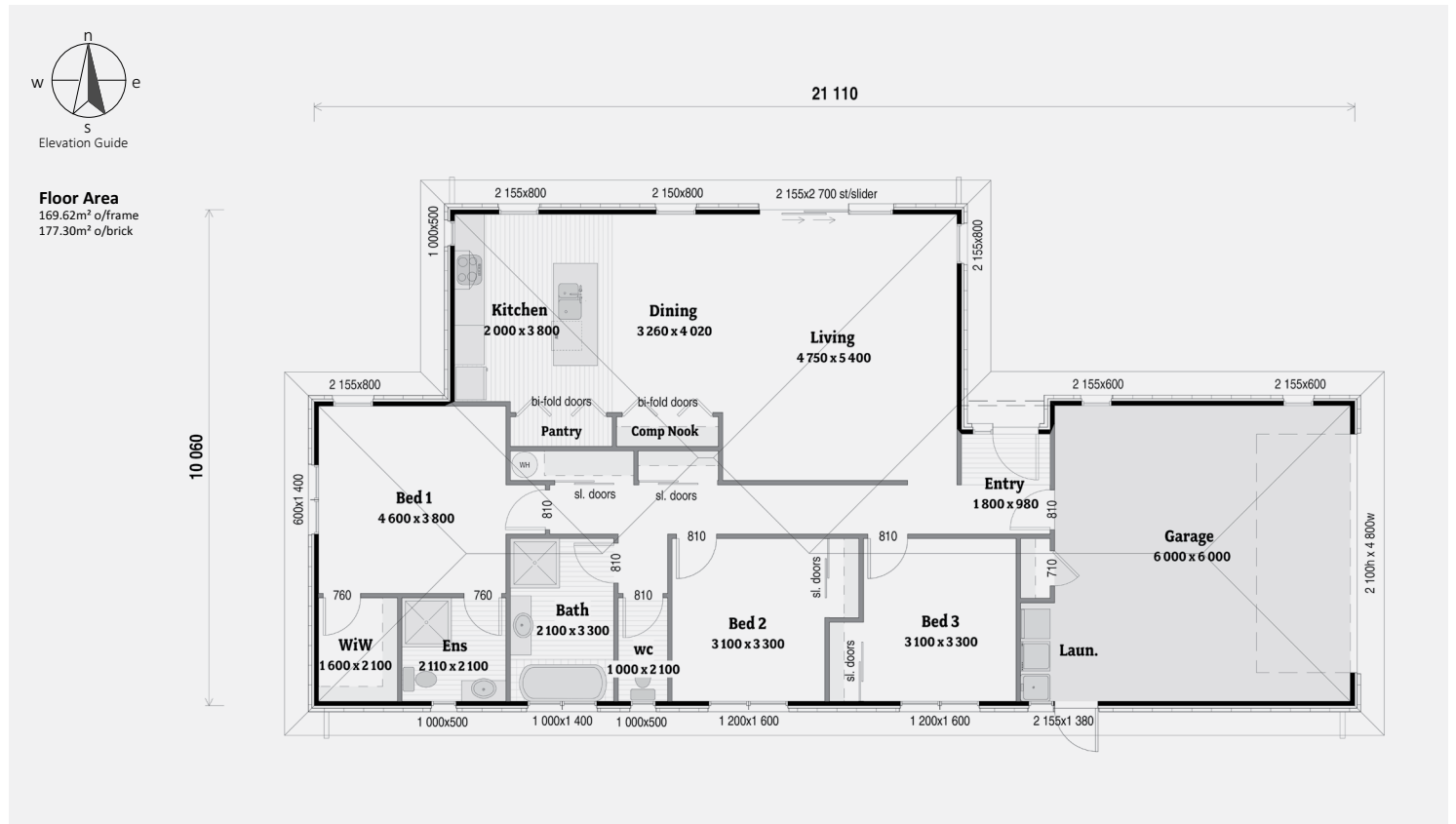



Floor Area

169.62m² o/frame
177.30m² o/brick

