

Kererū

3 Bdrm / 152m²

Your first home? An investment property? Downsizing? The compact, astute design of Kererū opens up your options. You have three bedrooms plus the potential to convert the study to a fourth bedroom.



3 BEDROOMS



1 LIVING ROOM



1 TOILET



✓ STUDY



2 CAR GARAGE



1 BATHROOM



✓ LAUNDRY



Artists Impression Only

KEY FEATURES OF THIS HOME

- Brick veneer and weatherboard cladding
- Open plan living
- Double garage

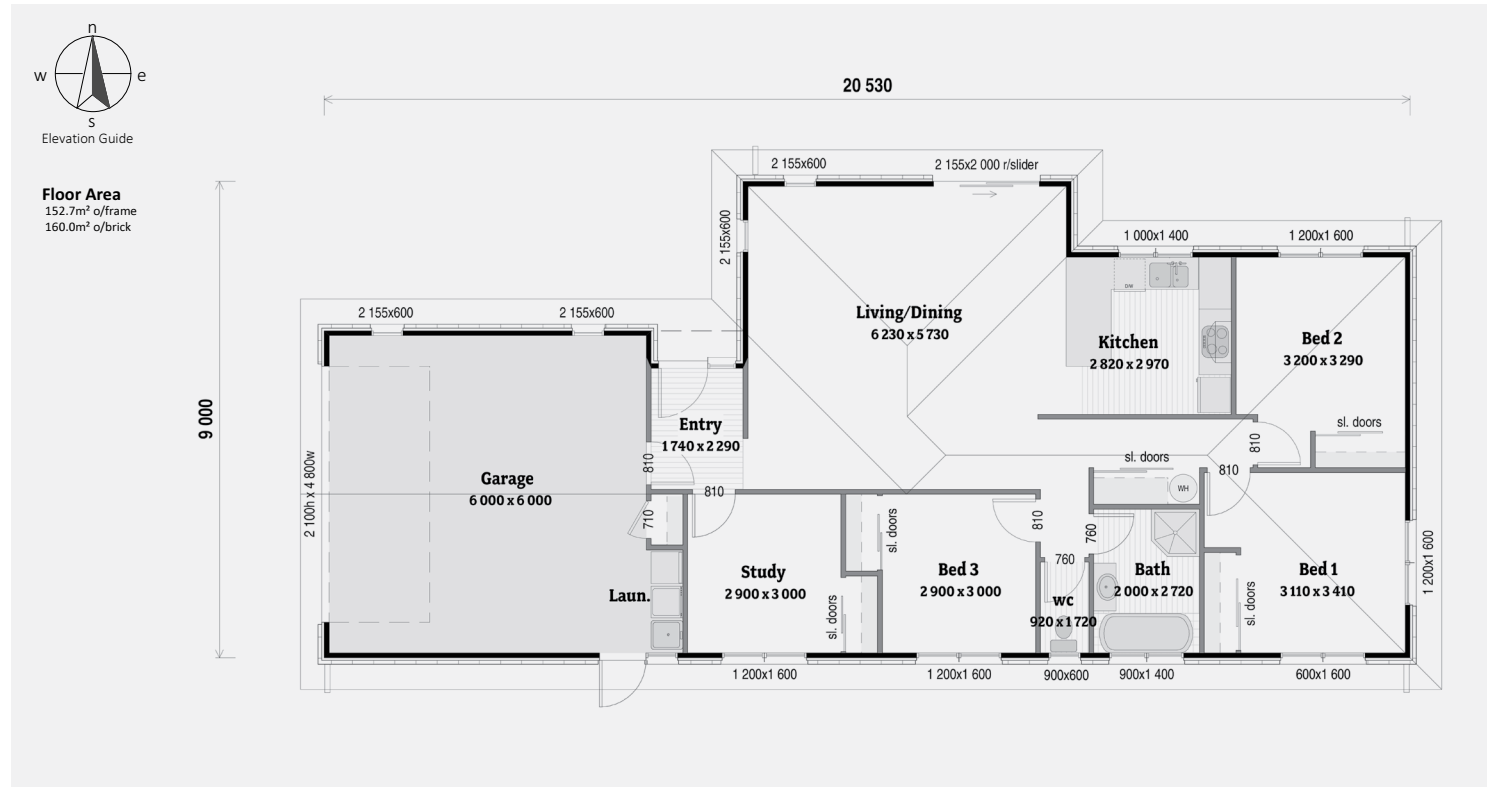

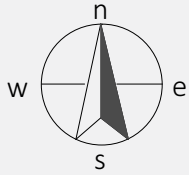

Elevation Guide

Floor Area
152.7m² o/frame
160.0m² o/brick

