



# Tūi



## 4 Bdrm / 194m<sup>2</sup>

A stylish, classic New Zealand home. Tūi offers spacious living and dining areas, pivoting around the kitchen's central island. Perfect – you can prepare meals and refreshments and still be right in on the conversation.

 4 BEDROOMS  
 2 CAR GARAGE

 3 LIVING ROOMS  
 1 WALK-IN ROBE

 2 TOILETS  
 1 ENSUITE

 1 BATHROOM  
 ✓ LAUNDRY



Artist's Impression Only

### KEY FEATURES OF THIS HOME

- Brick veneer and weatherboard cladding
- Open plan living
- Double garage

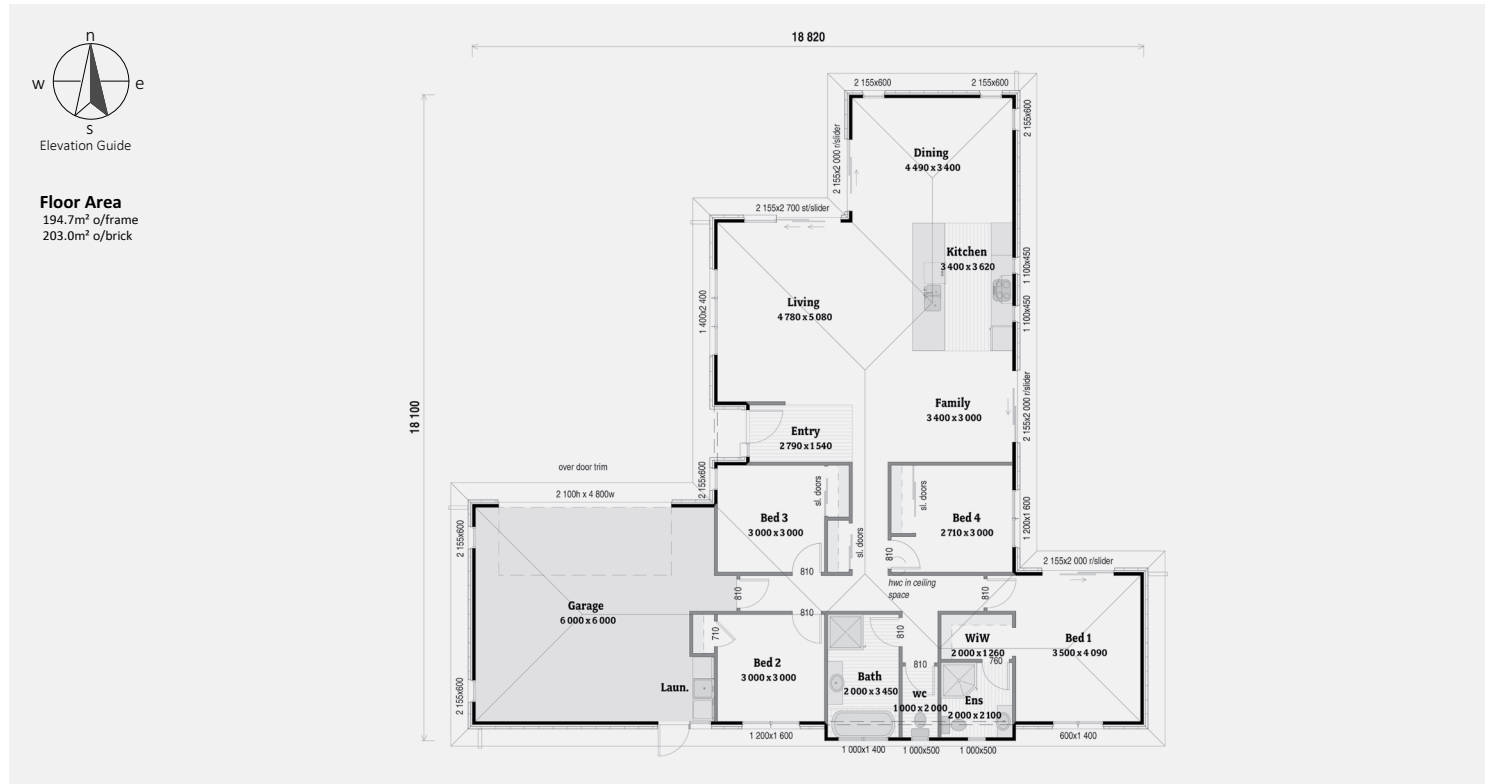

Always check the LBP Register to ensure your building practitioner is licensed.

Certified Plans are brought to you by Certified Builders - New Zealand's Most Qualified Builders.

[www.certifiedplans.co.nz](http://www.certifiedplans.co.nz)



**Floor Area**  
 194.7m<sup>2</sup> o/frame  
 203.0m<sup>2</sup> o/brick

